

# The 3-phase Hybrid

SH5.0RT / SH6.0RT / SH8.0RT / SH10RT

**INSTALLATION & COMMISSIONING  
WITH LG | BYD BATTERY**

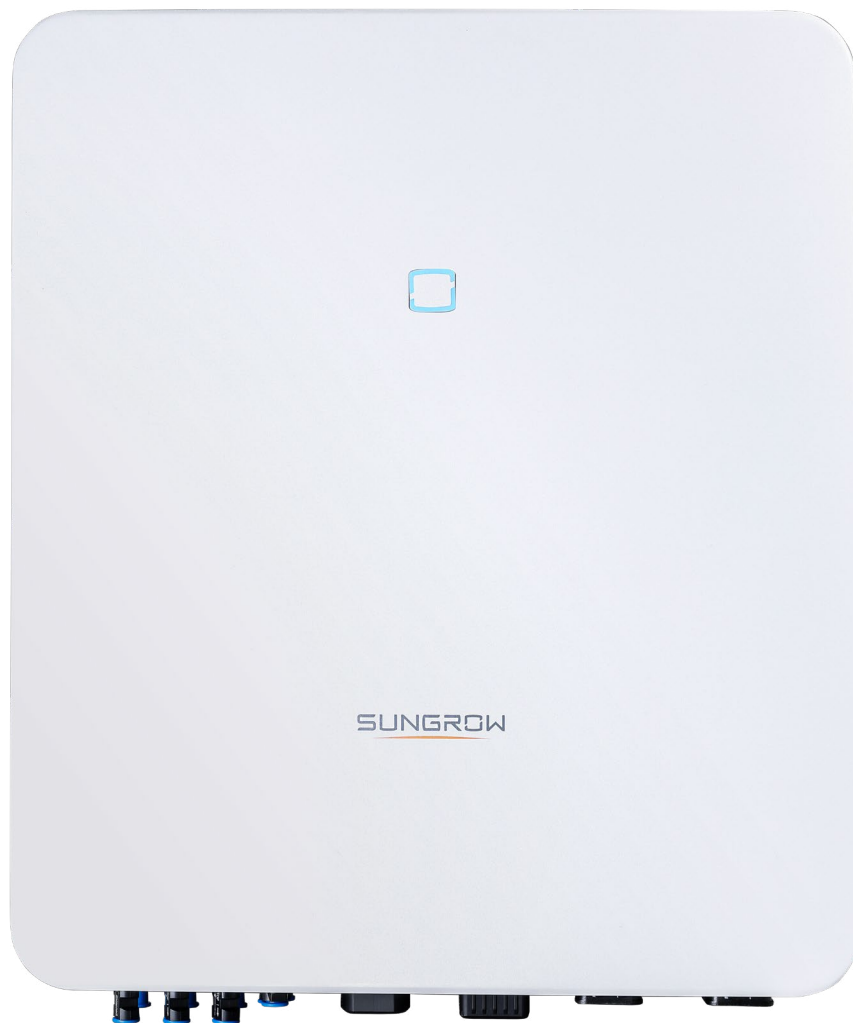



# INSTALLATION & COMMISSIONING WITH LG BATTERY

## 1 OPEN BATTERY

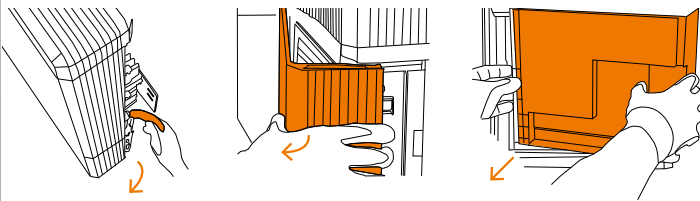

## 2 CONNECT POWER CABLES

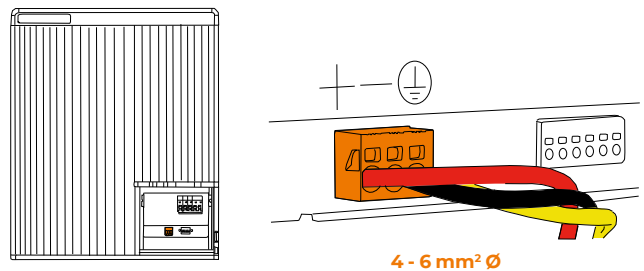

## 3 CHECK CABLE POLARITY

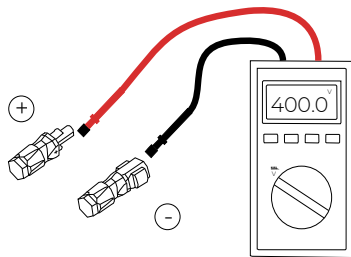

## 4 ASSEMBLE SUNCLIX CONNECTOR

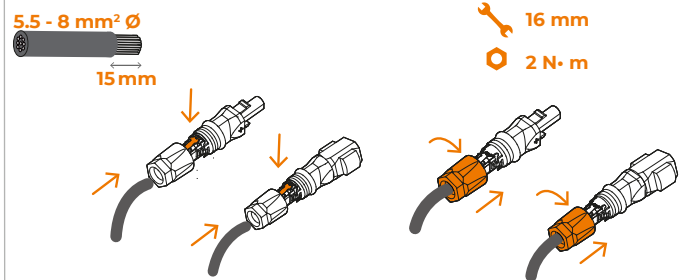

## 5 CONNECT INVERTER

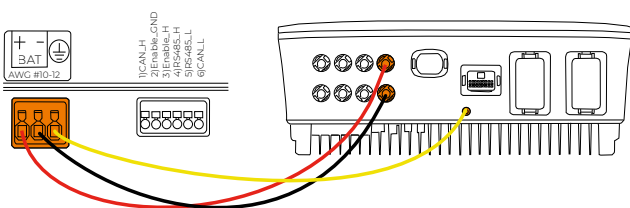

## 6 ATTACH COMMUNICATION CABLES

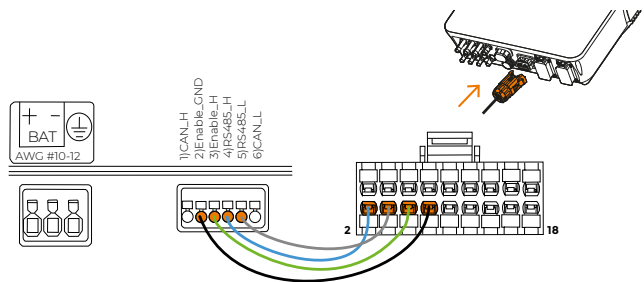

## 7 SWITCH ON BATTERY

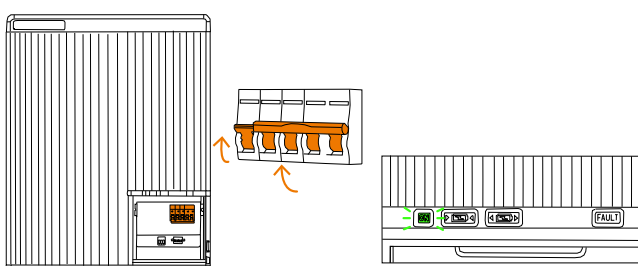

## 8 OPEN iSolarCloud

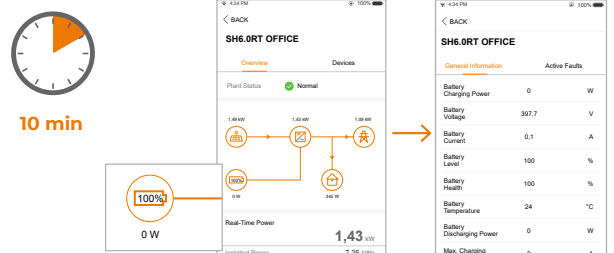



# INSTALLATION & COMMISSIONING WITH BYD BATTERY

## 1 CONNECT POWER CABLES

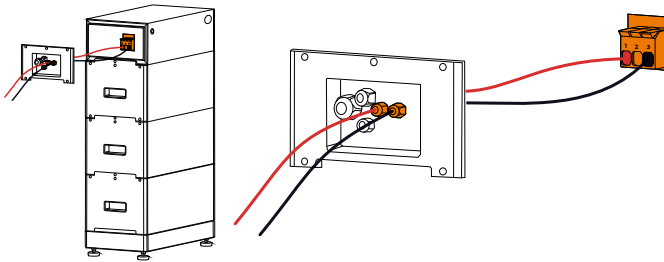

## 2 SECURE GROUNDING CONNECTION

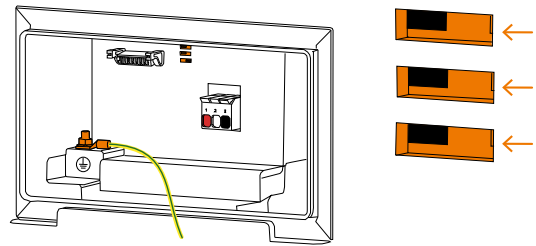

## 3 CHECK CABLE POLARITY

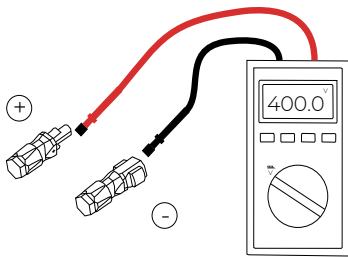

## 4 ASSEMBLE SUNCLIX CONNECTOR

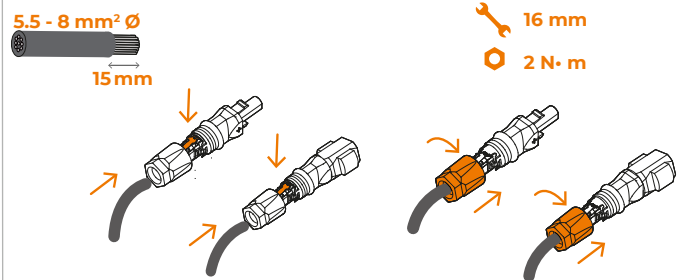

## 5 ATTACH COMMUNICATION CABLES

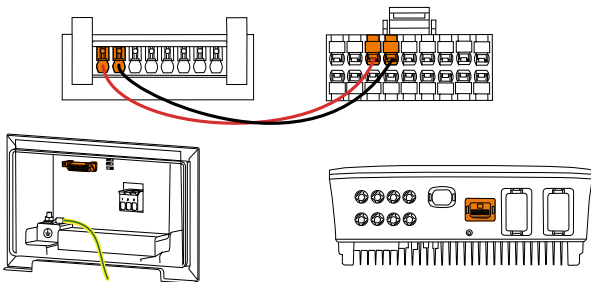

## 6 SWITCH ON BATTERY

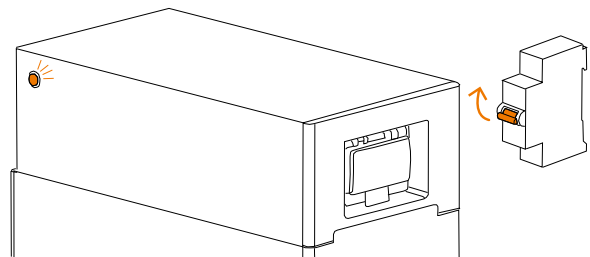

## 7 SET UP BYD Be Connect

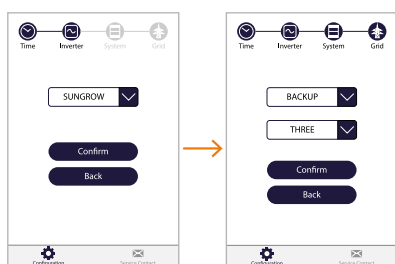

## 8 OPEN iSolarCloud

